

KENT

OWNER'S MANUAL

OPERATION • CARE • SERVICE

FLOOR MACHINE ACCESSORIES

SOLUTION TANK ACCESSORY KIT



PDF Version of manual by:
Michigan Company Inc.
2011 N. High St.
Lansing, Mich. 48906
(517) 484-9312
<http://www.Michco.com>

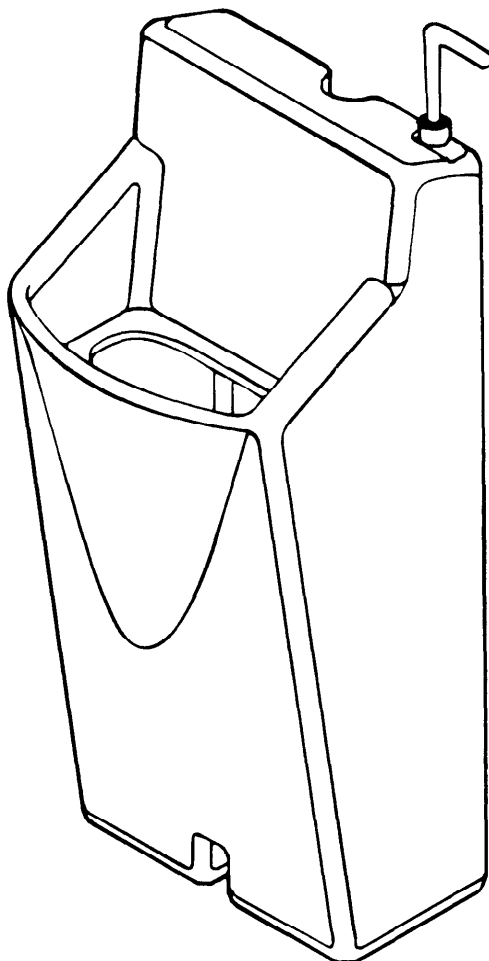

THE KENT COMPANY • 2310 INDUSTRIAL PARKWAY • P.O. BOX 1665 • ELKHART, IN 46515, U.S.A.
TEL: (219)293-8661 • (800)334-1083 • **FAX:** (219)295-8610 • **TELEX:** 25-8331 KENT CO EKA

IMPORTANT SAFETY INSTRUCTIONS

When using an electrical appliance, basic precautions should always be followed, including the following:

READ ALL INSTRUCTIONS BEFORE USING THE MACHINE!



WARNING:



FAILURE TO FOLLOW THESE SAFETY INSTRUCTIONS COULD RESULT IN DAMAGE TO THE MACHINE, DAMAGE TO PROPERTY, BODILY INJURY, OR DEATH.

- Use only as described in this manual. Use only manufacturer's recommended attachments.
- Do not use in areas where flammable and or explosive vapor or dust is present to avoid the possibility of fire or explosion. Some cleaning fluids can produce such vapors.
- Wet floor surfaces can be dangerously slippery. Always place "Caution Wet Floor" signs in the area that you are cleaning.
- Store your machine indoors in a cool, dry area. Do not expose the machine to temperatures in excess of 120°F or lower than 35°F for extended periods of time. Freezing solution can result in damage to the pump, solution plumbing, and tanks.
- Keep your work area well lighted.

SAVE THESE INSTRUCTIONS

UNPACKING

Carefully inspect all components to insure that there is no concealed freight damage. If such damage is discovered, file a Damage Report immediately with the delivering carrier.

ASSEMBLY AND INSTALLATION

STEP 1

Remove the tank assembly from the shipping carton.

STEP 2

Remove thumb screw (detail 15), located on the back side of the solution tank, and pivot the mounting bracket (detail 18).

STEP 3

Place the tank assembly on the front side of the handle and on top of the cord retainer. Rotate the mounting bracket (detail 18) and replace the thumb screw (detail 15) to secure the tank assembly to the handle. Be sure that the cord retainer is securely fastened to the handle. If the cord retainer should become loose, the tank assembly may be permitted to rotate around the handle.

STEP 4

For KF-Series models (with vinyl guard around motor), install the bent copper tube (detail 10) into the solution feed opening in the machine frame. Note: Some machines have undersized holes. If the machine has an undersized hole, drill the hole out using a 13/32 inch diameter (0.406 inch or approximately 10 millimeter) drill from underneath the machine.

For KF-"A" Series models (with roto-molded motor cover), remove the label on top of the motor cover, remove the three (3) screws, and lift the roto-molded motor cover off the floor machine frame. Install the bent copper tube (detail 10) into the solution feed opening in the machine frame. Slide the vinyl tubing (detail 9) onto the copper tube (detail 10) and secure them in location with the hose clamp (detail 21). Secure the hose clamp by placing the clamp under the screw that is used for securing the motor power cord to the frame, found in the front of the handle tee. For best results, route the vinyl tubing on the handle, on the opposite side of the power cord.

STEP 5

Reassemble the machine in the reverse order of disassembly. The machine and solution tank are now ready for use. While using the floor machine, grasp the control rod and pull to feed solution to the brush. When the control rod is released, the solution will stop.

SOLUTION TANK ASSEMBLY AND PARTS LIST

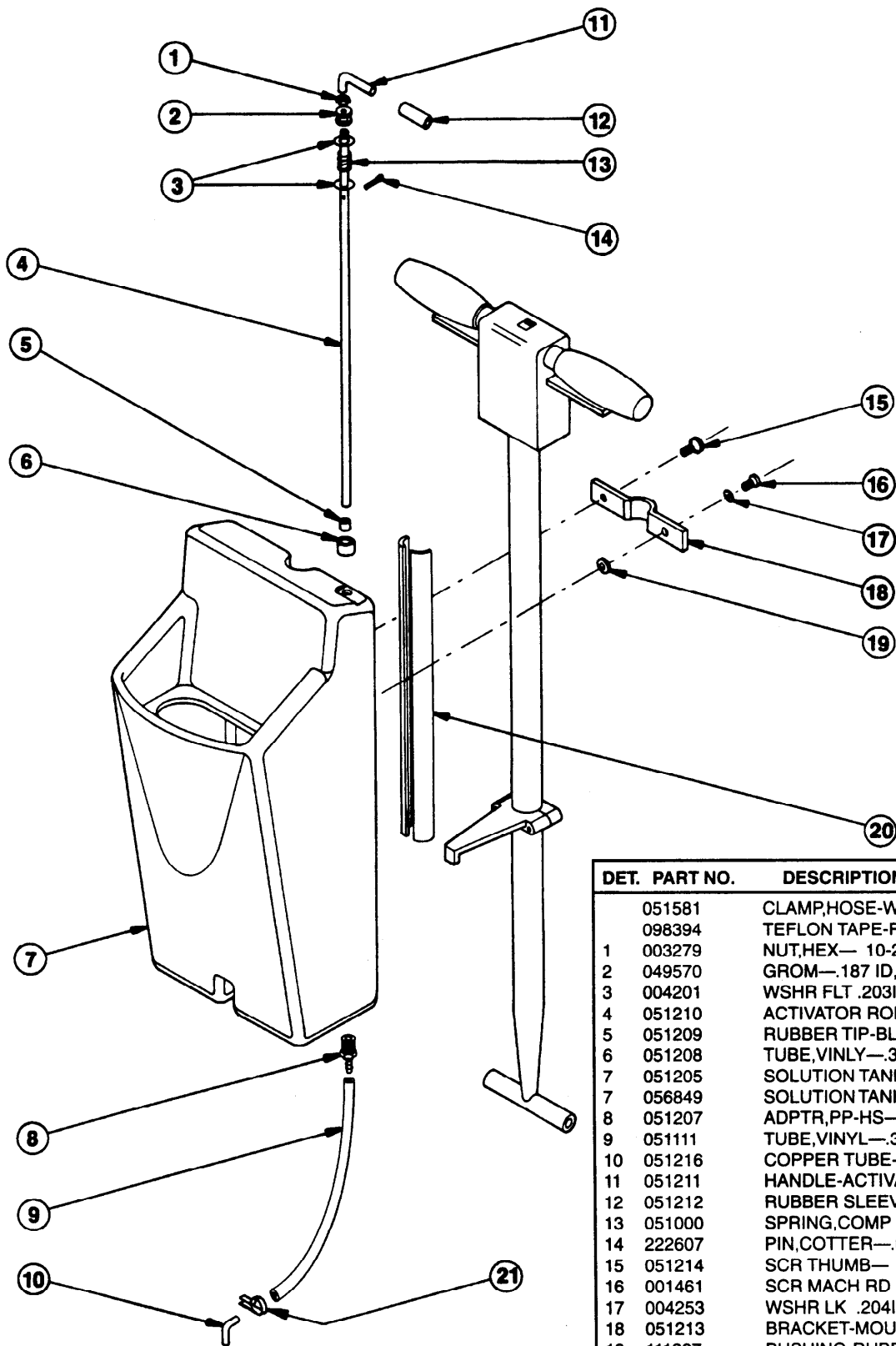

DET.	PART NO.	DESCRIPTION	QUANT.
	051581	CLAMP,HOSE-WORM (not shown)	1
	098394	TEFLON TAPE-PIPE THD SEALNUT	A/R
1	003279	NUT,HEX— 10-24,ZN PLT	1
2	049570	GROM— .187 ID.,.375 MHD.,.187 PA	1
3	004201	WSHR FLT .203ID.500OD.036T BRS	2
4	051210	ACTIVATOR ROD-S S 300 SERIES	1
5	051209	RUBBER TIP-BLACK	1
6	051208	TUBE,VINLY—.375X.500, .25L	1
7	051205	SOLUTION TANK MACHINED--BLUE	1
7	056849	SOLUTION TANK,MACHINED--BLACK	1
8	051207	ADPTR,PP-HS—1/2 MPTX3/8HS,PLS	1
9	051111	TUBE,VINYL—.375X.625,20.00L,R	1
10	051216	COPPER TUBE-CURVED 3" LONG	1
11	051211	HANDLE-ACTIVATOR ROD MACH	1
12	051212	RUBBER SLEEVE-2.37 LONG	1
13	051000	SPRING,COMP .390D .890L .045WD	1
14	222607	PIN,COTTER—.062X .500 LONG	1
15	051214	SCR THUMB— 10-32X.500L KNURL	1
16	001461	SCR MACH RD HD 10-32X.625L	1
17	004253	WSHR LK .204ID.410OD.025T EXT	1
18	051213	BRACKET-MOUNTING 'FAB'	1
19	111287	BUSHING-RUBBER	1
20	051215	GASKET-SUPPORT	1
21	051474	CLAMP,LOOP—.609 CLOSED I.D.	1

THE KENT LIMITED WARRANTY

Your Kent equipment which has been manufactured, tested, and inspected in accordance with carefully specified engineering requirements, is warranted to be free from defects in material and workmanship. This warranty is, however, subject to the following qualifications, conditions, and limitations which are set forth to provide you and all users of the equipment with information concerning the duration, extent, availability, and applicability of the Kent limited warranty, the procedure to be taken to obtain its performance, and other information concerning the Kent warranty policy.

The Kent Limited Warranty is extended to the original end user as follows

All Kent cord electric machines with the exception of upright and two motor upright vacuums have a three year warranty on parts, and one year labor coverage. Upright and two motor upright vacuums have a one year parts and labor warranty. Motor and gear unit assemblies on 175 RPM Floor Machines carry a warranty of five years.

Poly components carry a ten year replacement warranty with one year service labor. This warranty will not cover damage attributable to the following:

- : Improper, unreasonable or negligent use or abuse of the equipment.
- : Use of the equipment with hot water (over 130 deg. F , 54 deg. C).
- : "Warping", "Creepage", or "Distortion" of the part so long as the same does not interfere with normal operation.
- : Abrasions or punctures of the equipment.

The start date of the warranty coverage shall be the date the machine was shipped from the factory, or with proof of purchase, the purchase date of the original end user. The start date of the warranty shall not exceed one year from the ship date from the factory.

Parts of Kent Equipment not covered by the Kent Limited Warranty

Certain parts of Kent Equipment require replacement in the ordinary course of use due to normal wear by reason of their characteristics. These are normal wear items such as cords, squeegee blades, belts, gaskets, bumpers, carbon brushes, filters, hoses, bags, padholders, brushes, etc.

Exceptions and Exclusions from Warranty

This equipment is required to be used on electric current as indicated on the dataplate. Otherwise damage, defects, malfunctions or other failures of the equipment arising from the use on electric current not as indicated are excepted and excluded from this warranty. Defects, malfunctions, failure, or damage of the equipment caused by improper care, unreasonable or negligent use or abuse of the equipment are likewise excluded from this warranty. If repair is done to the equipment by anyone other than those designated as authorized to perform such work without having obtained factory authorization in writing, the Kent Company at its sole option, may determine that this warranty will not apply and that reimbursement for such repair will not be made because of the failure to comply with such factory instructions.

Procedure to be taken to obtain performance of warranty repair

To secure repair of the equipment or any warranted parts under this warranty, the following procedure must be taken. The inoperative equipment or warranted parts together with satisfactory evidence of the purchase date, must be delivered, with shipping and delivery charges prepaid, to one of the following:

- : The dealer from whom purchased.
- : Any Kent distributor's service department in the United States.
- : Any Kent authorized service station in the United States.

If you are unable to locate any of the foregoing, you may write or otherwise communicate with The Kent Company for instructions before repair service is performed by anyone else. In such event, The Kent Company will provide either the location of a Kent authorized service department or other factory instructions. In the event that no local service department is available, Kent at its discretion will repair or replace the part or equipment at the factory, the products will be returned to the owner freight prepaid. No warranty will be honored without proof of purchase, the model number, and serial number if applicable.

Replacement

In the event of a defect, malfunction, or failure of your Kent equipment or any warranted part to conform with this warranty, The Kent Company may, at its sole option and own expense, replace the equipment or any warranted part with another new identical or reasonably equivalent model or part in lieu of repairing the defect.

No refund of purchase price

The Kent Company will not, as a matter of its warranty policy, refund the customer's purchase price.

Warranty registration

Your Kent Company distributor from whom you purchased your equipment is responsible for the registration of your warranty with the factory. We ask that you cooperate with your distributor in supplying the necessary information on the warranty card so that we may better serve you. Any information or questions that you may have concerning your Kent equipment or this warranty may likewise be secured from the factory. This warranty gives you specific legal rights, and you may also have other rights which vary from state to state.